

Reproduction, dissemination or use of this document or its contents in any form without the prior written permission of TURASAS, is prohibited. Offenders will be liable for the payment of damages. All rights reserved in the event of the grant of a patent, utility model or industrial design registration.

Section cut A-A
Scale: 1:2
Typical

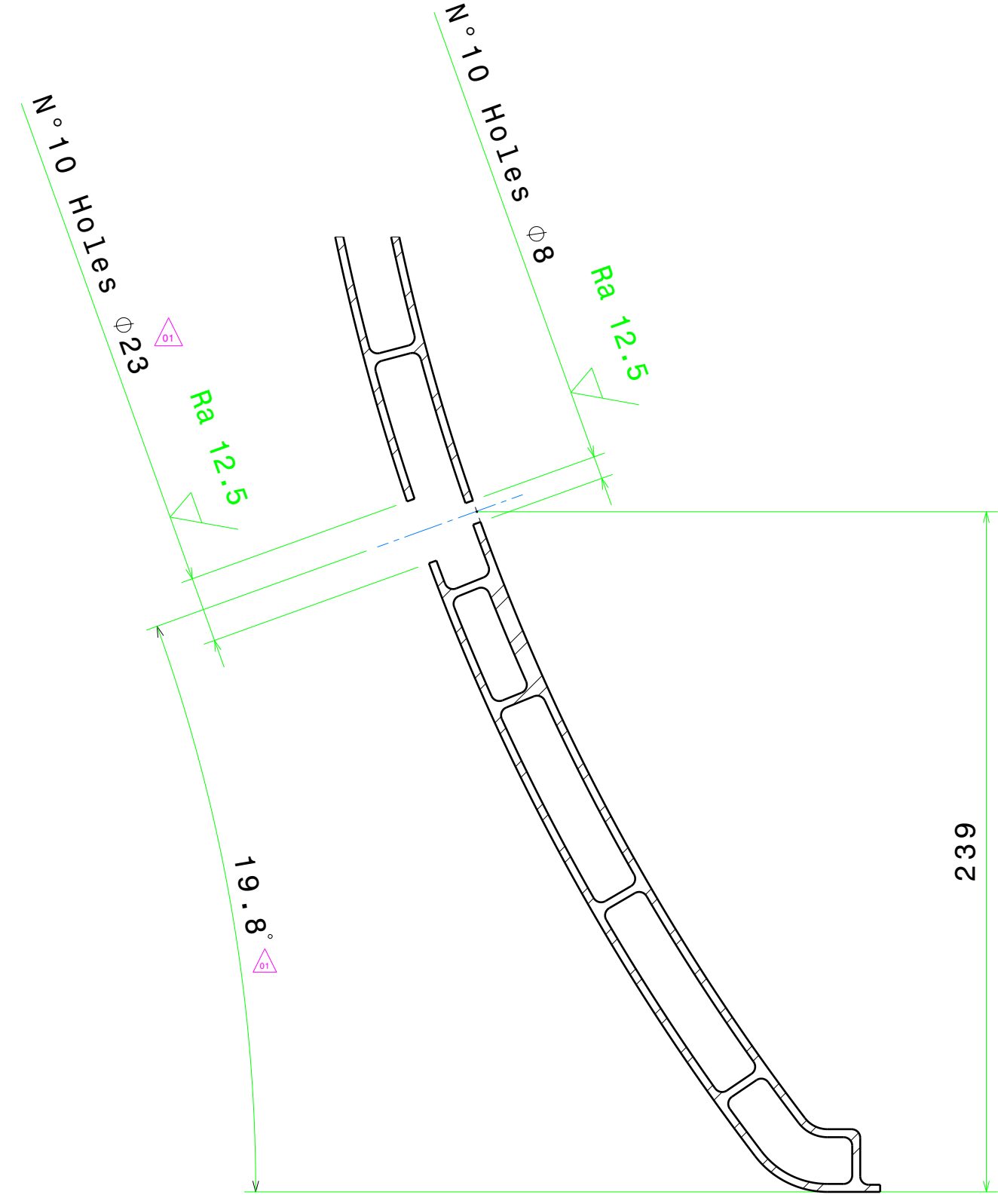

Isometric view

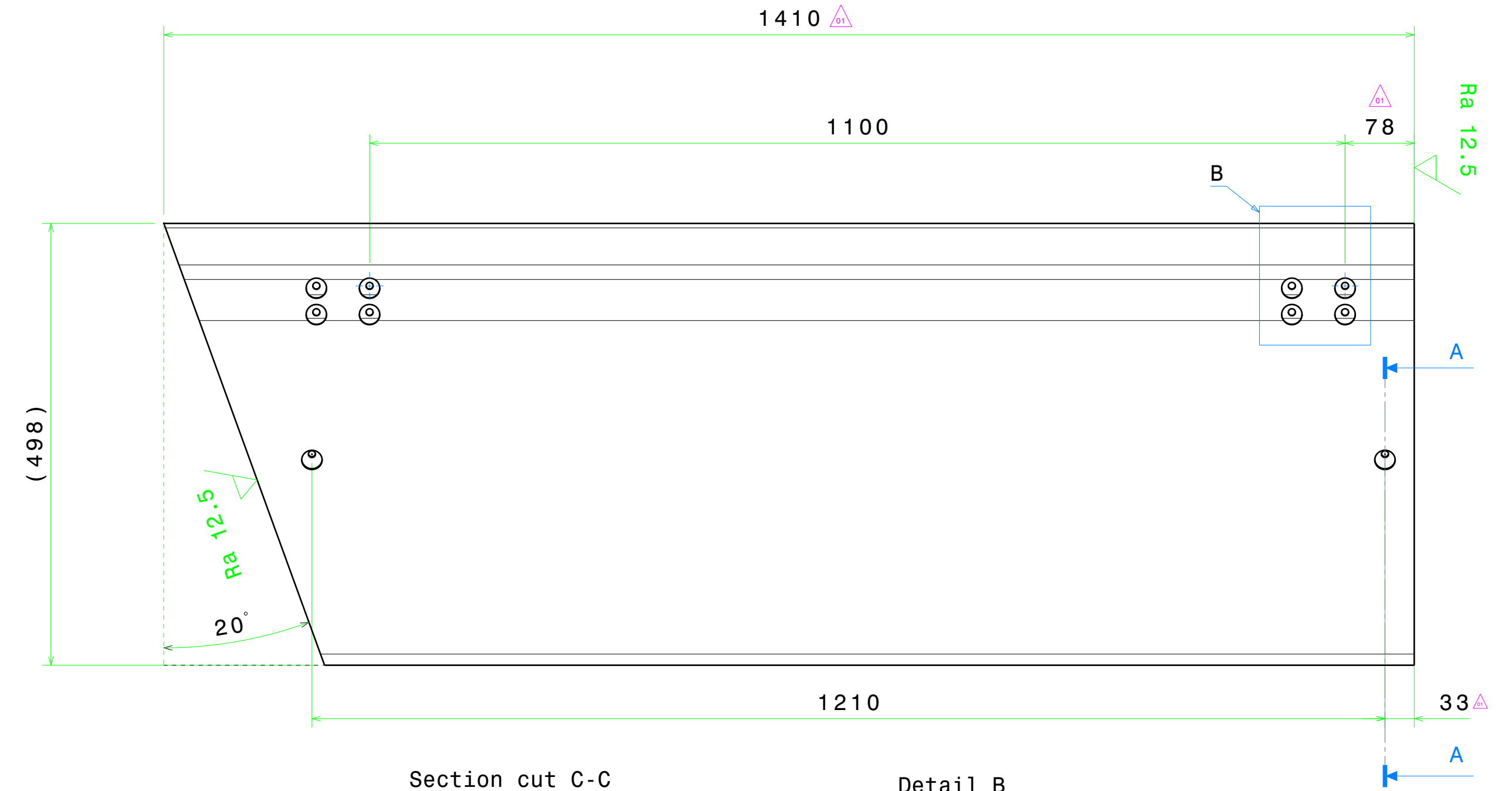
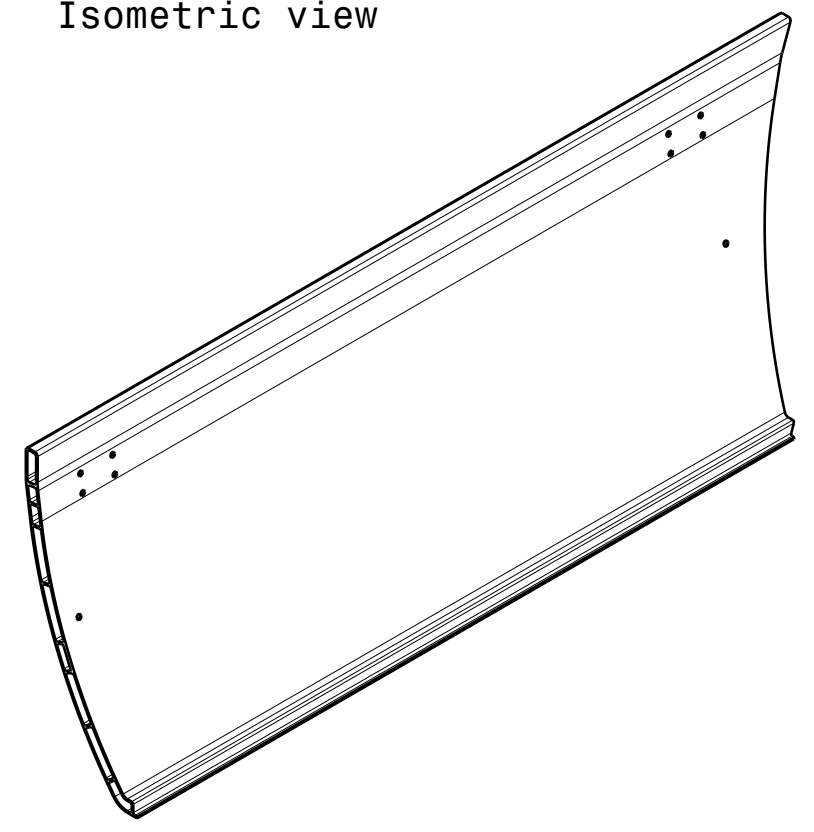

Section cut C-C
Scale: 1:2
Typical

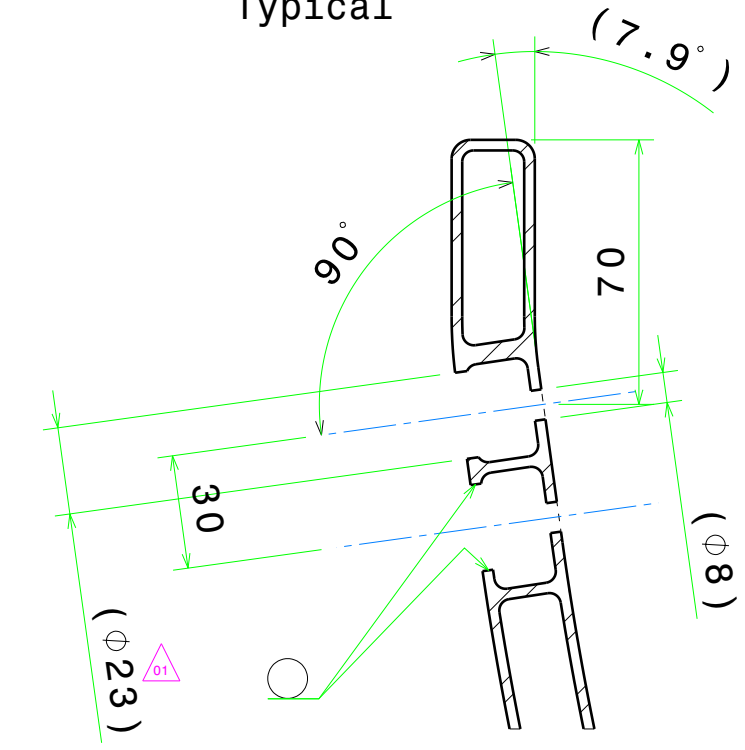

Detail B
Scale: 1:2
Typical

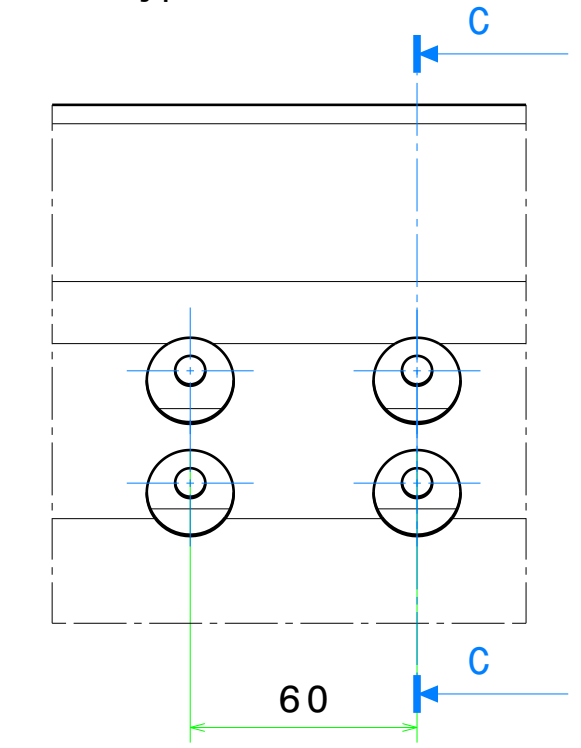

For profile dimensions refer to drawing: GZ10.21.12.99000

<1000	6,0	0,8
<630	4,0	0,7
<400	3,0	0,6
<250	3,0	0,4
100	2,0	0,3
40	1,5	0,2
L mm	Ham	Ypl.
Nom. Size	Class	
<4000	2,0	0,4
<2000	1,2	0,4
<1000	0,8	0,3
<400	0,5	0,3
30-120	0,3	0,2
2-30	0,2	0,1
L mm	m ±	K ±
Nom. Size	Class	
>20000	9,0	8,0
<20000	8,0	7,0
<16000	7,0	6,0
<12000	6,0	5,0
<8000	5,0	4,0
<4000	4,0	3,0
<2000	3,0	2,0
<1000	2,0	1,5
<400	1,0	1,0
30-120	1,0	0,5
2-30	1,0	0,5
L mm	A ±	E ±
Nom. Size	Class	

Technical Specifications					
Technical Document					
Fixture/Mould Asset ID.					
Coating/Heat Tre./Roughness		01	Drawing Update	13/01/2024	A.Türkmen
Paint/Color	-	Mod. No	Modification Description	Date	Sign

Edge without dimension according to DIN ISO 13715

-0.3 +0.3

Tolerance for holes and shafts without marks on drawing

Hole H12-Shaft h12

No	Parça Adı Designation Name of Item	Adet Qty.	Resim No / Norm Drawing No / Norm	Malzeme Material	Ölçü Dimension	Ağırlık Weight (Kg)
	ISO 21920-1	ISO 8015	ISO 2553	General Tol.	ISO 2768	f mX H K
	EN 15085-2 Certification Level	CL1 CL2 CL3	Weld Pro.	ISO 13920	A B E F	
	Approved	L.Giovinazzo	27/01/2023	Scale	ISO 12708	Lm2 Lr2 Sm2 Sr2
	Checked	M.Borlo	27/01/2023	1:5		
	Prepared	M.Cojocar	27/01/2023			
	Outer_Lower_Panel					
	-					
	Date: 27/01/2023			Sheet : 1/1 Size: A2 Rev: 01		

TURASAS

Turkish Railway Vehicles Industry Inc.

GZ11.21.12.11001